

FORM NO. 1.

Courses and Distances down
the River are as follow.

N. 27. W. 53.
N. 3. E. 16.
N. 19. E. 88.
N. 4. E. 54.
N. 3. W. 24.
N. 16. W. 22.
N. 3. E. 24.
N. 11. E. 26.
N. 34. E. 21.
N. 41. E. 32.
N. 47. E. 22.
N. 62. E. 16.
N. 71. E. 16.
N. 84. E. 14.
S. 76. E. 20.
S. 62. E. 26.
S. 55. E. 19.
S. 44. E. 35.
S. 25. E. 46.
S. 43. E. 44.
S. 23. E. 26.
S. 10. W. 28.
S. 19. W. 89.
S. 16. W. 38.
S. 7. E. 73.

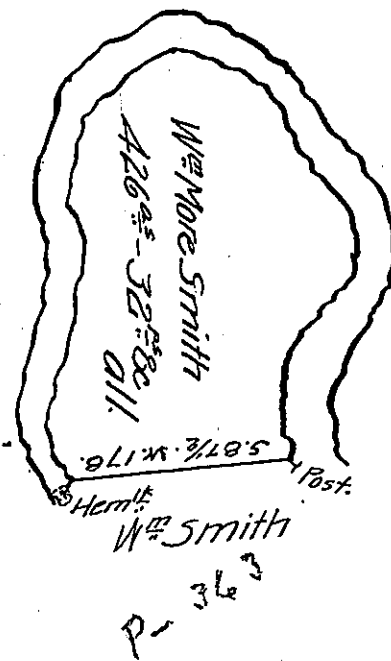

Situate on the South Side of the West Branch of Susquehanna
River in the first big bend above the Mouth of big Masthannon Creek.
Huntingdon County Franktown Township containing 426^{ac} 32^{pr}
and the Usual Allowance for Roads

Surveyed the 8th Day of September 1794 For William M. Smith in
pursuance of a Warrant dated the 30th Day of January 1794.

John Canon. D.S.

Daniel Brodhead Esq. S.G.

IN TESTIMONY that the above is a copy of the original remaining on file in
the Department of Internal Affairs of Pennsylvania, made
conformably to an Act of Assembly approved the 16th day of
February, 1833, I have hereunto set my Hand and caused
the Seal of said Department to be affixed at Harrisburg,
this Twentyfifth day of January 1907.

Isaac R. Brown
Secretary of Internal Affairs.